



www.fortuneandcoates.co.uk

FORTUNE & COATES

The People's Estate Agent



48 Doulton Close, Harlow, CM17 9RG

Asking price £350,000

Situated in this always popular area on the sought after Church Langley development, offering easy access to the local supermarket and schools is this immaculately presented two bedroom end terrace home in Doulton Close. To the ground floor, you are presented a large lounge as well as a spacious kitchen/diner with doors leading out to your rear garden. To the first floor of this bright and airy home you are offered two well proportioned bedrooms and an impressive family bathroom. Externally, this property comprises an ideal rear garden with the perfect ratio of lawn to patio area, as well as a garage en-bloc to the front of the property.

Entrance Hallway

Lounge 14'9 x 9'9 (4.50m x 2.97m)

Kitchen/Diner 12'9 x 7'10 (3.89m x 2.39m)

First Floor Landing

Bathroom

Bedroom One 12'10 x 9'3 (3.91m x 2.82m)

Bedroom Two 11'4 x 6'10 (3.45m x 2.08m)

Floor Plan

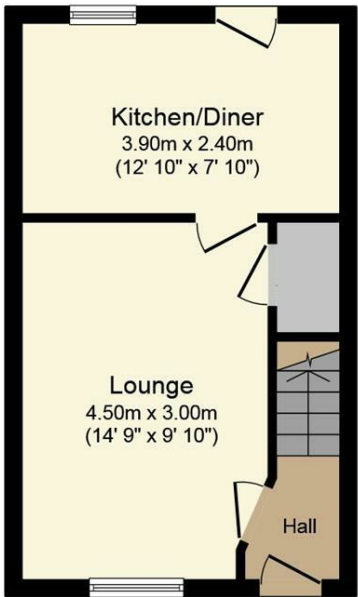

Ground Floor

Floor area 26.3 sq.m. (283 sq.ft.) approx

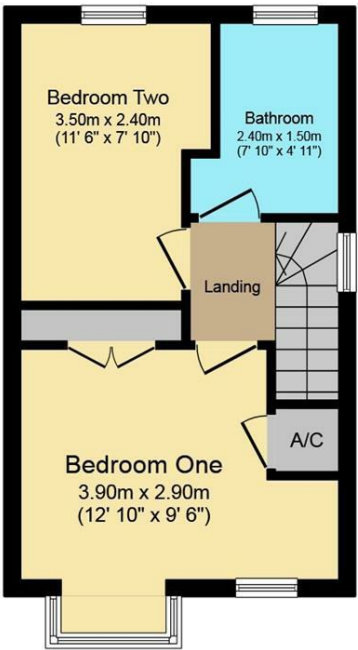

First Floor

Floor area 27.0 sq.m. (291 sq.ft.) approx

Total floor area 53.4 sq.m. (574 sq.ft.) approx

This Floor Plan is for illustration purposes only and may not be representative of the property. The position and size of doors, windows and other features are approximate. Unauthorized reproduction prohibited. © PropertyBOX

Area Map



Energy Efficiency Graph

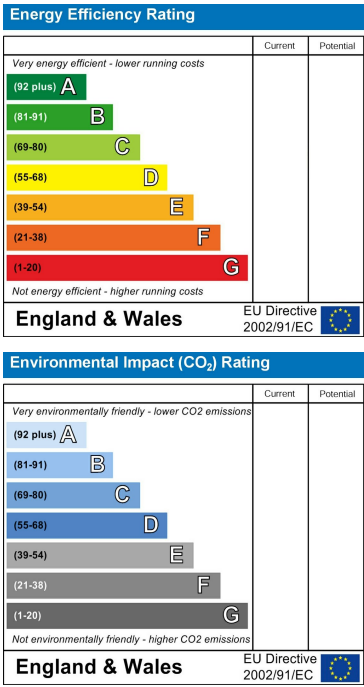

These particulars, whilst believed to be accurate are set out as a general outline only for guidance and do not constitute any part of an offer or contract. Intending purchasers should not rely on them as statements of representation of fact, but must satisfy themselves by inspection or otherwise as to their accuracy. No person in this firms employment has the authority to make or give any representation or warranty in respect of the property.